







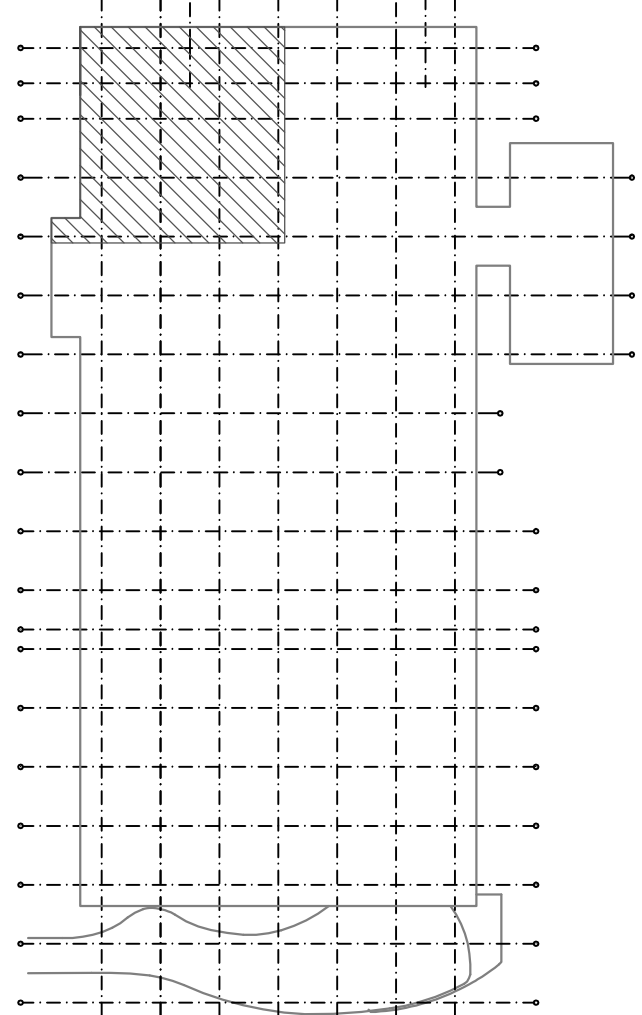

PRÍVODNÝ POTRUBÍ	PRÍVODNÝ ANEOSTAT
ODVODNÝ POTRUBÍ	ODVODNÝ ANEOSTAT
TEPELNÁ ISOLÁCIA	PRÍVODNÁ VÝSTUKA
TEPELNÁ ISOLÁCIA	ODVODNÁ VÝSTUKA
MECHAN. POTRUBÍ NA CHLADIVO	ODVODNÝ TAIROVÝ VENTIL
POŽARNÁ KAPKA	KAZETOVÝ FAN-COIL
   	    



±0,000 = 207,650 m n.m.

[illegible][illegible]